

Handling Guidelines for Working with SamplePro® FlexFilm Bags

- Do not overfill bags.

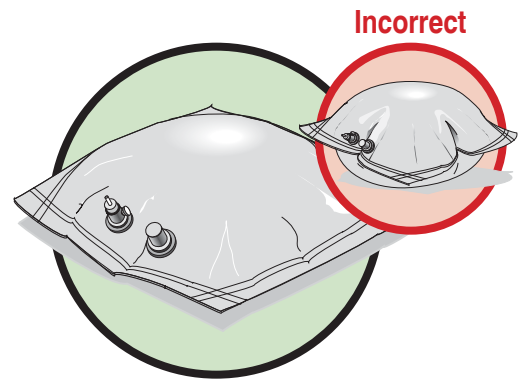

- Store bags flat. Do not roll or crease bags during storage.

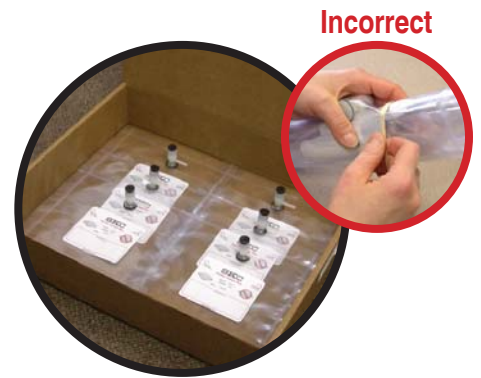

- Do not use bags at temperatures above 140 F (60 C).

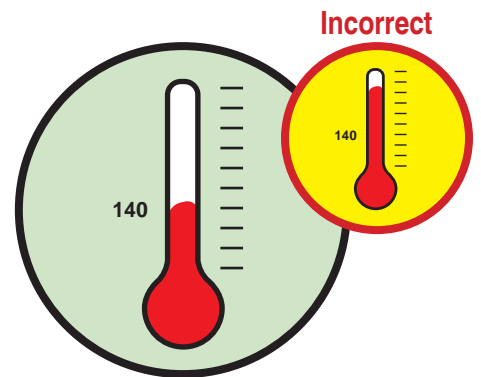

- Bags are designed for single use only.



www.skinc.com

Form #38027 Rev 1102



See FlexFilm Use Guidelines video at
www.skinc.com/videofolder/FlexFilmSampleBags.asp.