

Handling Guidelines for Working with SamplePro® FlexFilm Bags



www.skcinc.com

Form #38026 Rev 1304

- ☑ Do not overfill bags.

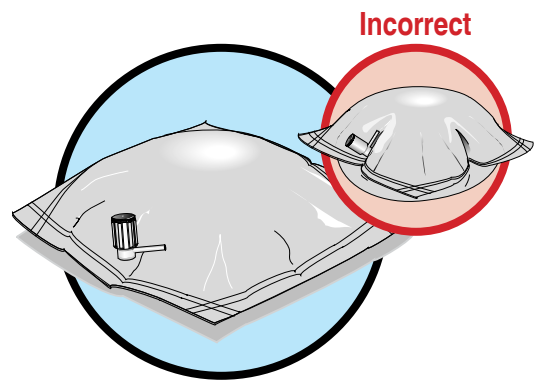

- ☑ Secure polypropylene valve when opening/closing by holding side stem while turning entire upper portion of fitting one revolution.



- ☑ Store bags flat. Do not roll or crease bags during storage.

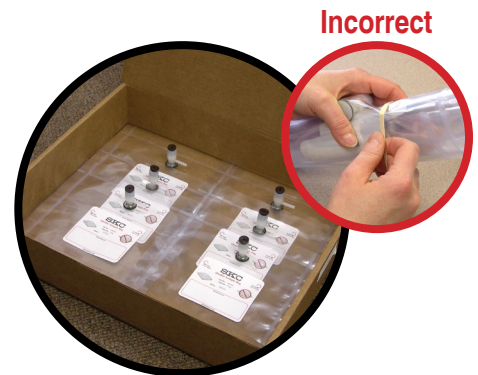

- ☑ Bags are designed for single use only.

