



AirChek 20 Sample Pump

Cat. No. 920-2000
Quick Guide

This Quick Guide covers basic operation of the SKC AirChek 20 Sample Pump. For complete pump operating instructions, go to www.skccinc.com/knowledgecenter.



Figure 1. AirChek 20 Pump Overview

Installing and Charging the Battery

Install. The AirChek 20 pump (Figure 1) is supplied without battery Cat. No. P920201 installed. Install the battery as follows:

1. Unfasten the six casing screws (three on each side of the case, see Figure 1) using supplied Pozidriv size PZ1 screwdriver. Lift off black casing cover.
2. Remove the two protective covers from the battery terminals and place battery in rear compartment of pump case as shown in Figure 2. Ensure that equal gaps are left between ends of battery and sides of case to allow for case screws to be screwed in fully without damaging battery.
3. Connect red battery cable from pump control PCB to red '+' terminal on battery, and black battery cable to black '-' terminal on battery.
4. Reinstall black casing cover, securing it with the six screws using Pozidriv size PZ1 screwdriver.

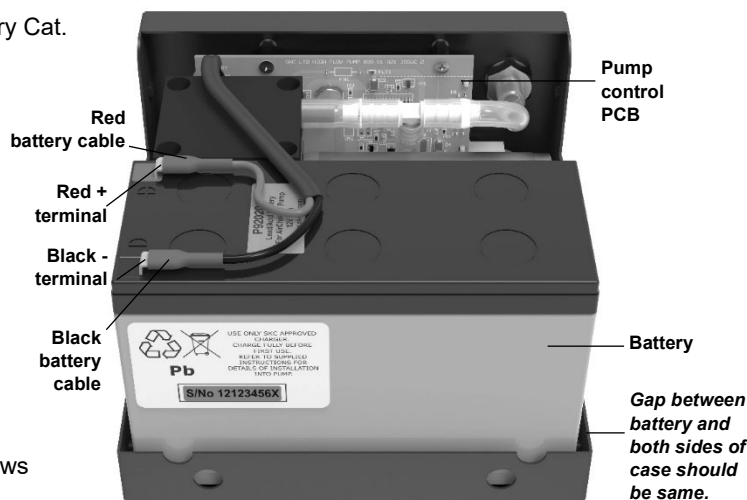

Figure 2. Installing the Battery

Charge. Before first use, the battery should be fully charged, ideally overnight.

AirChek 20 must only be charged using SKC Battery Charger Cat. No. 920-210.

- The battery charger can only be used to charge the battery when the pump is **not** running, and not when the pump is running to extend pump run time.
 - AirChek 20 can be powered by AC Adapter Cat. No. 920-211 suitable for 100-240 V or by an external high capacity 12V lead-acid battery (not SKC supplied) using external Battery Cable Cat. No. 920-212. It is recommended that these options be used in conjunction with internal battery Cat. No. P920201 to retain the pump program and run time data when external power supplies are disconnected.
1. Unscrew dust cap from charging/power socket on pump (see Figure 1) and connect output connector from charger to pump socket. Screw charging connector into socket to prevent it from detaching while charging.
 2. Plug charger into a 100 to 240 V wall outlet. LED indicator on charger will illuminate amber to indicate that charger is charging at full power.

- Battery Status
>>>> Good

SELECT Sleep
Run Setup Review

SKC AIRCHEK 20
SLEEPING

SKC AIRCHEK 20
SLEEPING

g SKC High Flow chek-

- SELECT Sleep
Run Setup Review

Set Clear Back
Flow RunTime

SET FLOW Back

>

Small text at the bottom: [illegible]

- SET FLOW Back
>>>>>>>>>>_

SET FLOW Back
 >>>>>>>>>>>>>Max

SET FLOW Back
 >>>>>>_____

SET FLOW Back
Min.....

SELECT Sleep
Run Setup Review

114

SELECT Sleep
Run Setup Review

ELAPSED RUN TIME
000:00:04

Reset 002:00:03

Free Technical Support: Rely on SKC Tech Support for the answers you need at skctech@skcinc.com.